

# Der 3-phasige Hybrid

SH5.0RT / SH6.0RT / SH8.0RT / SH10RT

**INSTALLATION & INBETRIEBNAHME  
MIT BATTERIE | LG | BYD**

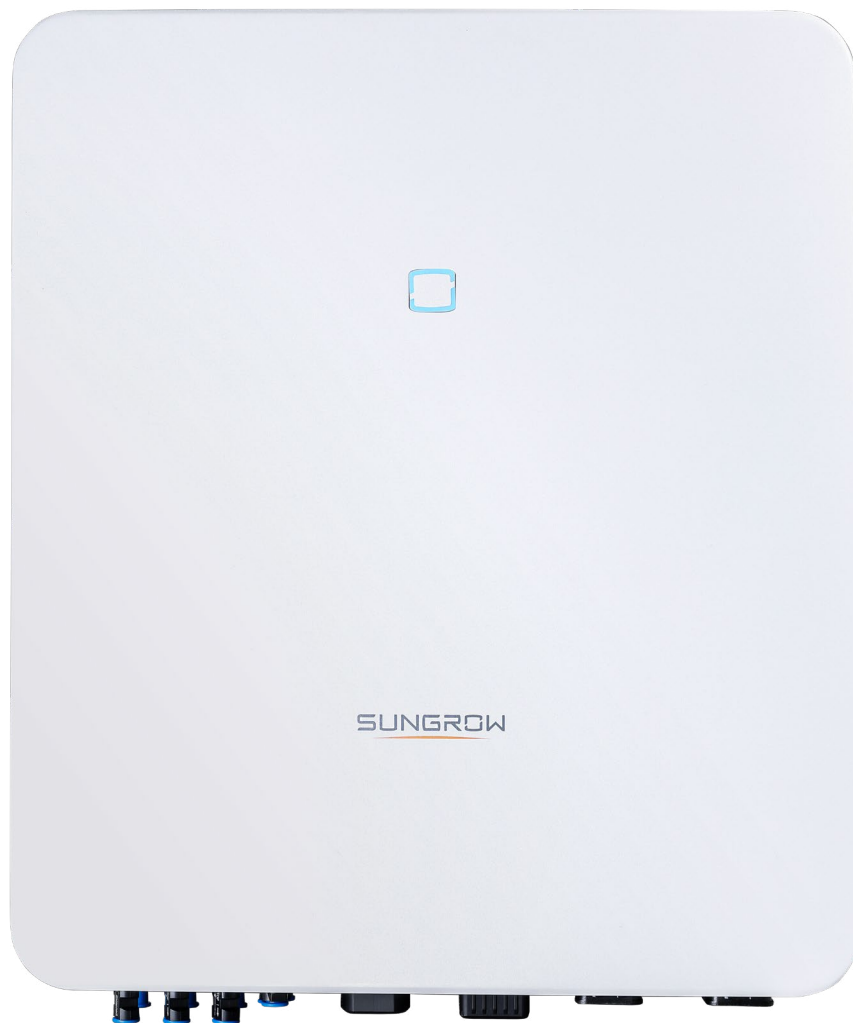



# INSTALLATION & INBETRIEBNAHME MIT LG BATTERIE

## 1 BATTERIE ÖFFNEN

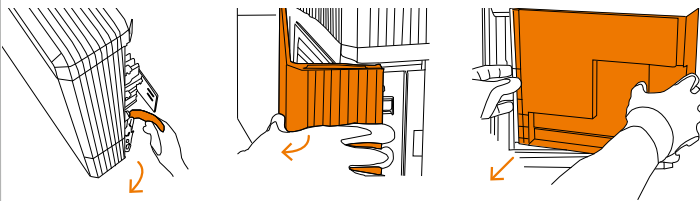

## 2 BATTERIE ANSCHLIESSEN

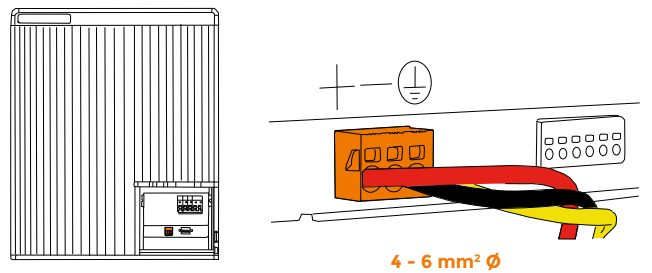

## 3 KABELPOLARITÄT ÜBERPRÜFEN

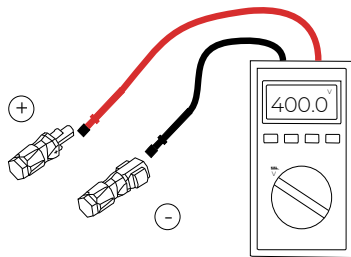

## 4 SUNCLIX ZUSAMMENBAUEN

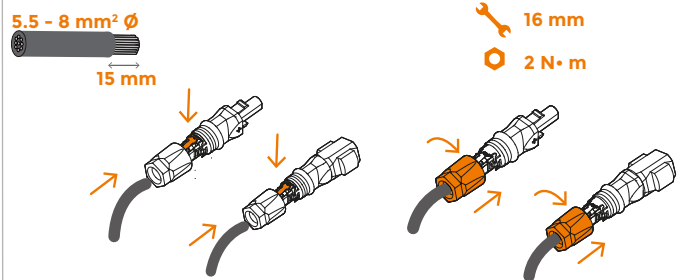

## 5 WECHSELRICHTER VERBINDEN

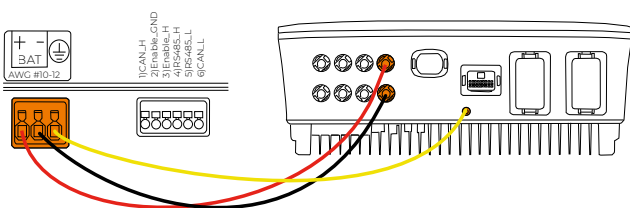

## 6 KOMMUNIKATION HERSTELLEN

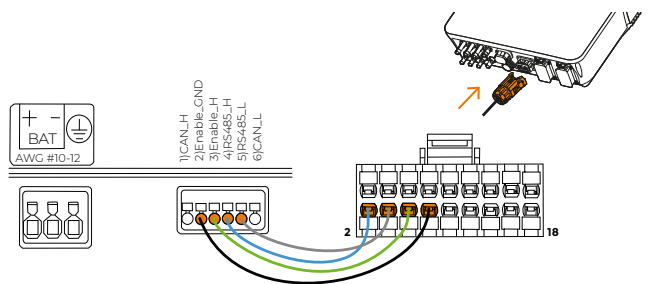

## 7 BATTERIE EINSCHALTEN

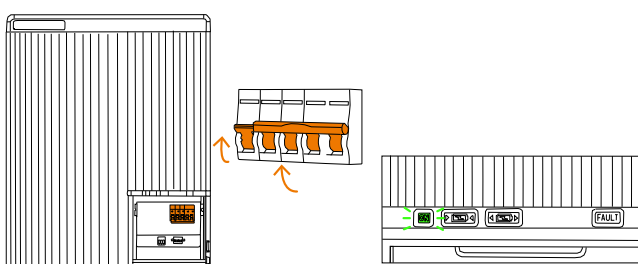

## 8 iSolarCloud ÖFFNEN



10 min.

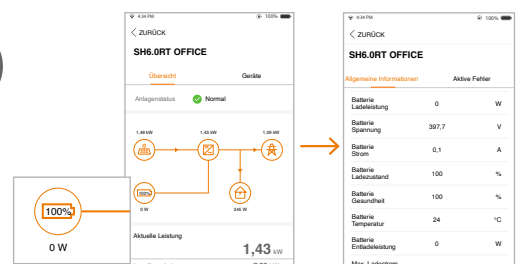



# INSTALLATION & INBETRIEBNAHME MIT BYD BATTERIE

## 1 BATTERIE ANSCHLIESSEN

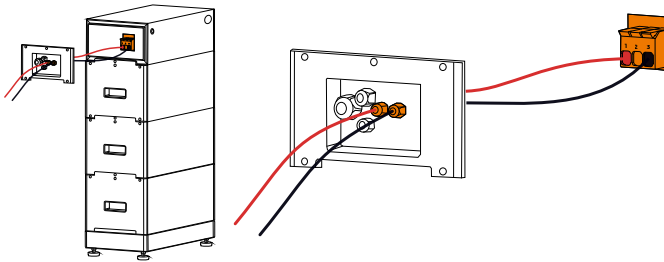

## 2 ERDUNG VERBINDEN

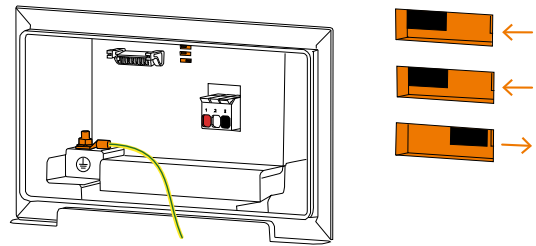

## 3 KABELPOLARITÄT ÜBERPRÜFEN

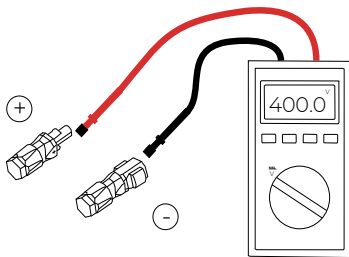

## 4 SUNCLIX ZUSAMMENBAUEN

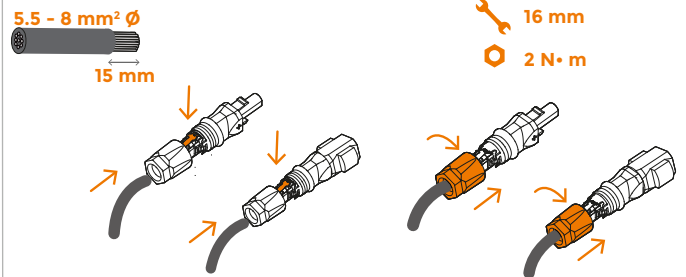

## 5 KOMMUNIKATION HERSTELLEN

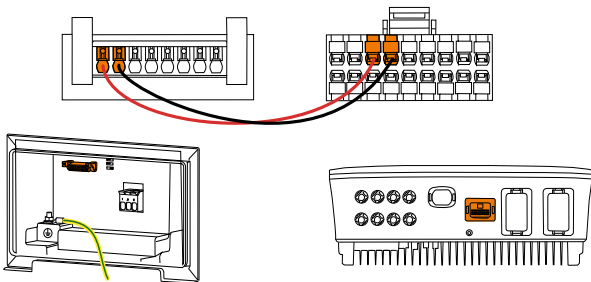

## 6 BATTERIE EINSCHALTEN

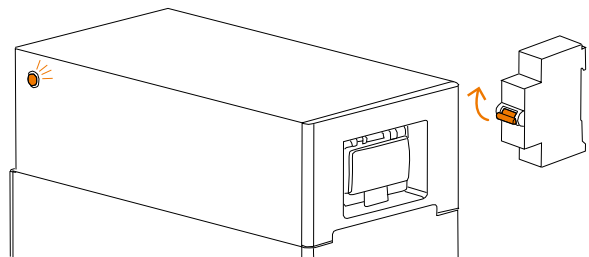

## 7 BYD Be Connect EINRICHTEN

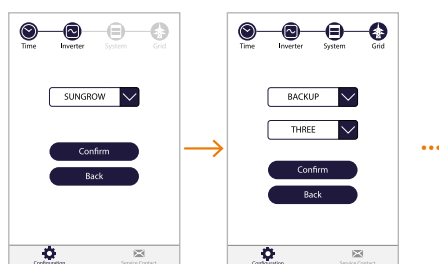

## 8 iSolarCloud ÖFFNEN

